

Fascia Cover LT

Part number 7

ANSI/SPRI ES-1 CERTIFIED:

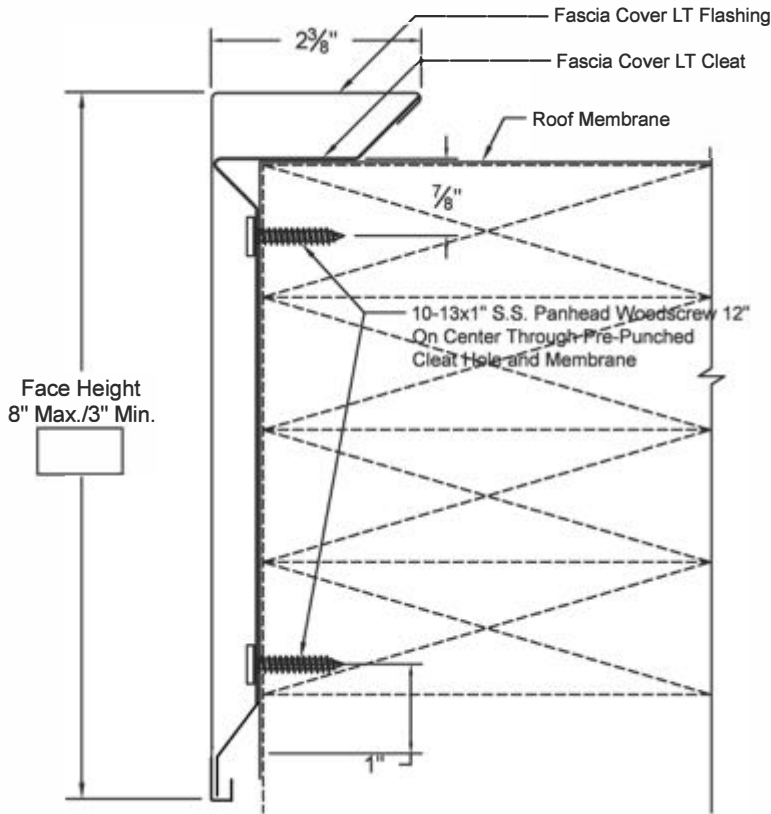

FACE HEIGHT	NAILER QTY.
8" max.	4
6"	3
4-1/2"	2
3" min.	1

- Continuous Cleat and Fasteners provided.
- Concealed Splice Plates provided.
- Continuous Cleat: 22GA 20GA

QUANTITIES:

Lineal Feet (10'-0" Lengths*): _____

Outside Miters** : _____ Optional Welded (Surcharge Applies)

Inside Miters** : _____ Optional Welded (Surcharge Applies)

Right End Caps** : _____ Optional Welded (Surcharge Applies)

Left End Caps** : _____ Optional Welded (Surcharge Applies)

Splice Plate Tape Sealant: Optional Sealant (Surcharge Applies)

* Optional lengths available up to 20'-0"

** Standard riveted

PRINT APPROVAL:

Architect and/or Contractor shall verify all dimensions, sizes, and quantities, All products to be installed in strict accordance with Jackson Architectural Metals printed instructions.

Approved By: _____

Date: _____

PROJECT: _____

ARCHITECT: _____

ROOFING CONTRACTOR: _____

REPRESENTATIVE: _____

MATERIAL:

24GA .040" AL
 Other: _____ .050" AL

Finish: _____

Color: _____

Carlisle

Firestone

Other



Jackson Architectural Metals, LLC
 1421 S. Cooper St Jackson, MI 49203
 PH: (517) 782-8884 /Fax: (517) 782-8906

www.jacksonamf.com